

Soils Map

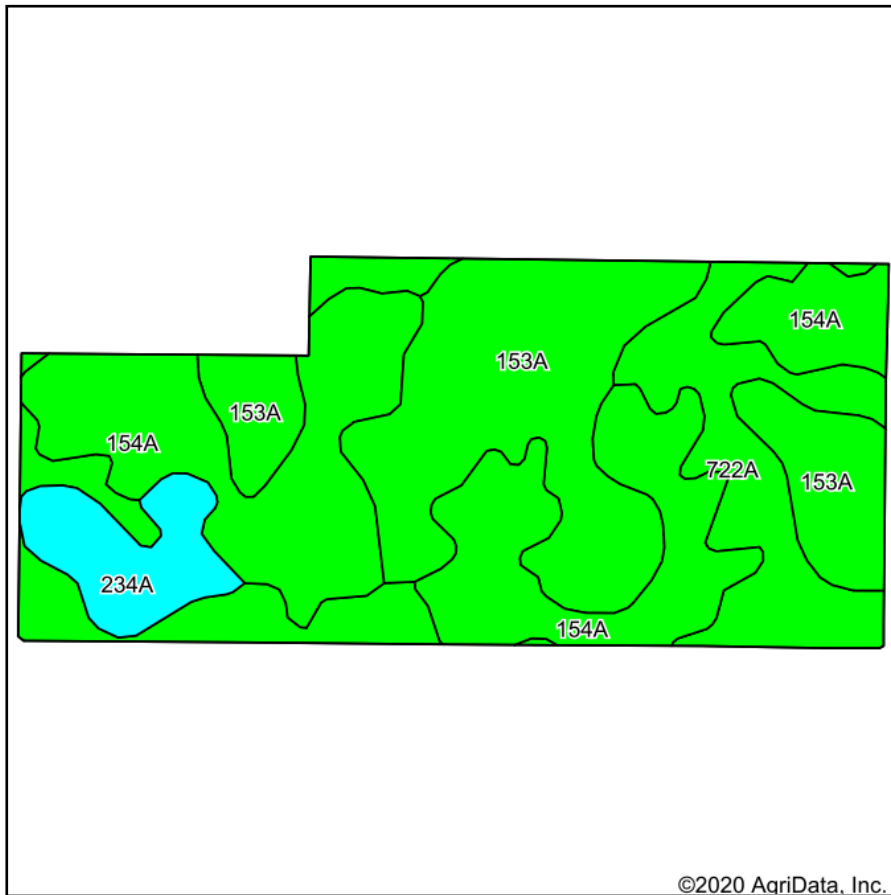

Soils data provided by USDA and NRCS.

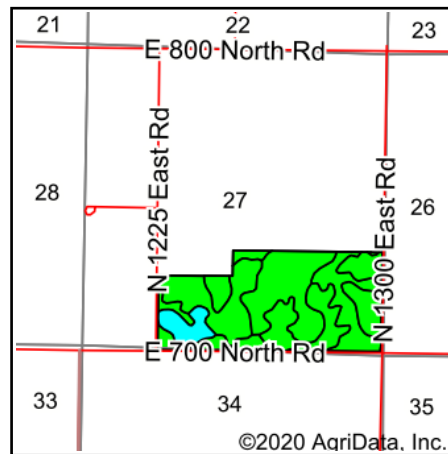

State: **Illinois**
 County: **Piatt**
 Location: **27-17N-6E**
 Township: **Bement**
 Acres: **145.71**
 Date: **8/31/2020**

Maps Provided By:



Area Symbol: IL147. Soil Area Version: 16							
Code	Soil Description	Acres	Percent of field	Il. State Productivity Index Legend	Corn Bu/A	Soybeans Bu/A	Crop productivity index for optimum management
154A	Flanagan silt loam, 0 to 2 percent slopes	54.36	37.3%		194	63	144
153A	Pella silty clay loam, 0 to 2 percent slopes	47.75	32.8%		183	60	136
722A	Drummer-Milford silty clay loams, 0 to 2 percent slopes	33.59	23.1%		184	60	137
234A	Sunbury silt loam, 0 to 2 percent slopes	10.01	6.9%		179	57	131
Weighted Average					187.1	60.9	138.9

Table: Optimum Crop Productivity Ratings for Illinois Soil by K.R. Olson and J.M. Lang, Office of Research, ACES, University of Illinois at Champaign-Urbana. Version: 1/2/2012 Amended Table S2 B811

Crop yields and productivity indices for optimum management (B811) are maintained at the following NRES web site: <http://soilproductivity.nres.illinois.edu/>

** Indexes adjusted for slope and erosion according to Bulletin 811 Table S3

Soils data provided by USDA and NRCS. Soils data provided by University of Illinois at Champaign-Urbana.