

# Soil Information - Clark County 77.0 Acres

## Soils Map

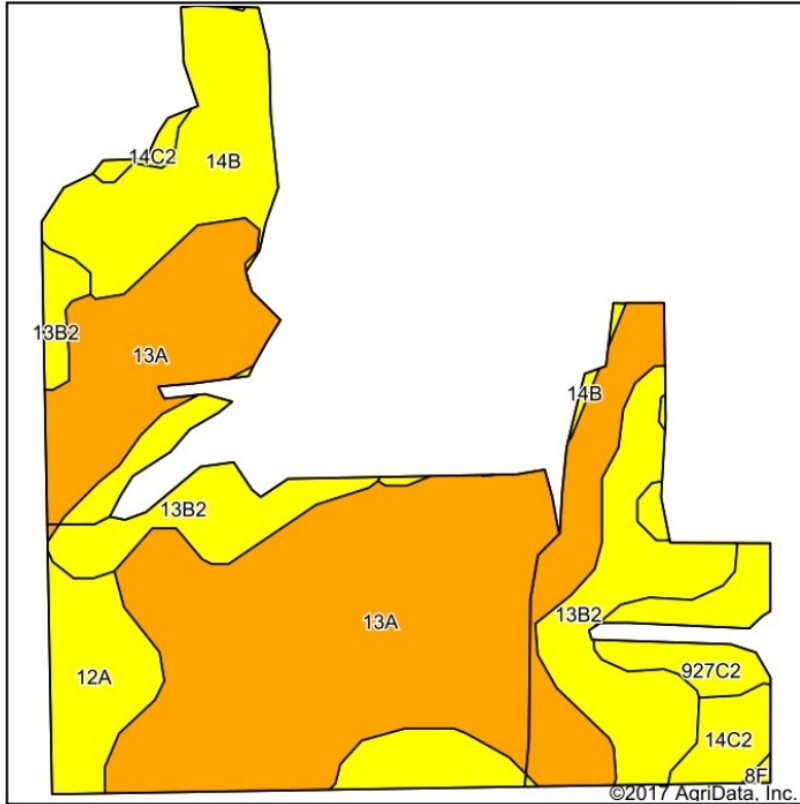

Soils data provided by USDA and NRCS.

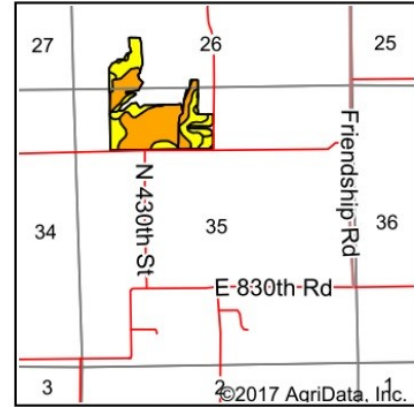

State: **Illinois**  
 County: **Clark**  
 Location: **35-10N-14W**  
 Township: **Casey**  
 Acres: **52.35**  
 Date: **10/10/2017**

Maps Provided By  
**surety**  
CUSTOMIZED ONLINE MAPPING  
 © AgriData, Inc. 2017 [www.AgriDataInc.com](http://www.AgriDataInc.com)



Area Symbol: IL023, Soil Area Version: 11

Code	Soil Description	Acres	Percent of field	Il. State Productivity Index Legend	Corn Bu/A	Soybeans Bu/A	Crop productivity index for optimum management
13A	Bluford silt loam, 0 to 2 percent slopes	28.10	53.7%		136	44	101
**13B2	Bluford silt loam, 2 to 5 percent slopes, eroded	11.24	21.5%		**129	**42	**96
**14B	Ava silt loam, 2 to 5 percent slopes	5.80	11.1%		**134	**44	**99
12A	Wynoose silt loam, 0 to 2 percent slopes	3.18	6.1%		128	42	97
**927C2	Blair-Atlas silt loams, 5 to 10 percent slopes, eroded	2.43	4.6%		**117	**40	**89
**14C2	Ava silt loam, 5 to 10 percent slopes, eroded	1.52	2.9%		**122	**40	**90
**8F	Hickory silt loam, 18 to 35 percent slopes	0.08	0.2%		**86	**29	**65
<b>Weighted Average</b>					<b>132.4</b>	<b>43.1</b>	<b>98.5</b>

**Table: Optimum Crop Productivity Ratings for Illinois Soil by K.R. Olson and J.M. Lang, Office of Research, ACES, University of Illinois at Champaign-Urbana. Version: 1/2/2012 Amended Table S2 B811**

Crop yields and productivity indices for optimum management (B811) are maintained at the following NRES web site:  
<https://www.ideals.illinois.edu/handle/2142/1027/>

\*\* Indexes adjusted for slope and erosion according to Bulletin 811 Table S3

Soils data provided by USDA and NRCS. Soils data provided by University of Illinois at Champaign-Urbana.